

FABRICATION NOTE:

- 1. REFER TO TOLERANCES - FABRICATION UNO
- 2. WELDS TO COMPLY WITH AS 1554-1
- 3. 5mm CONTINUOUS FILLET WELDS UNO
- 4. ALL SHEET & PLATE PROFILES TO BE MACHINE CUT FROM .DXF FILES, SOME DIMENSIONS OMITTED
- 5. REMOVE ALL BURRS & SHARP EDGES
- 6. \* DENOTES FORMED/ROLLED PROFILES
- 7. MATERIAL CERTIFICATE TO BE SUPPLIED

BOM:50202879\_CATALOGUE PRODUCTS

ITEM #	QTY.	PART #	DESCRIPTION	MATERIAL
1	1	50202879	GRATE AND FRAME GMS 900x362 SM2 BOLTDOWN WITH STAINLESS STEEL CAP HEADS M10x50 CLASS D (G93GSM2)	MS GR-250 GALV

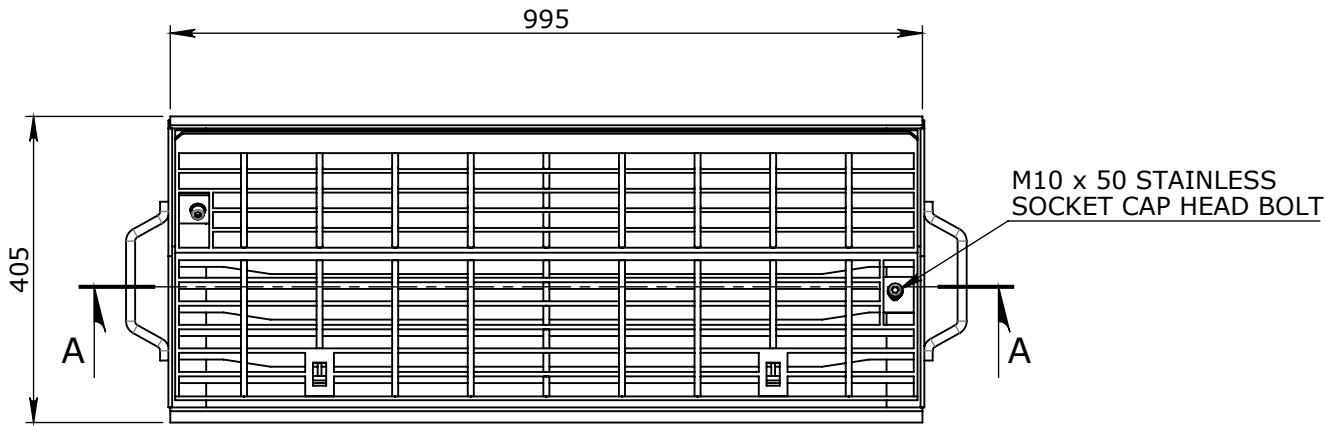

PLAN VIEW

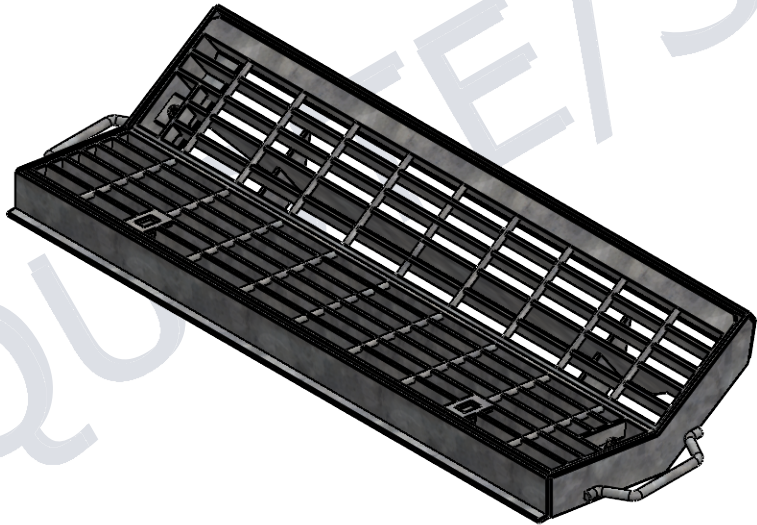

ISOMETRIC VIEW

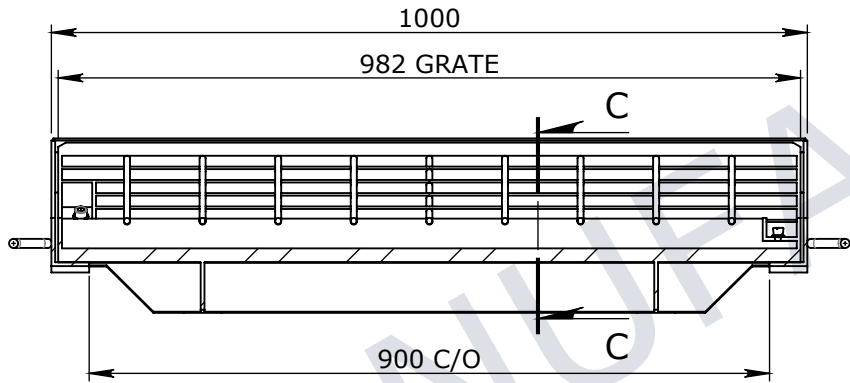

SECTION A-A

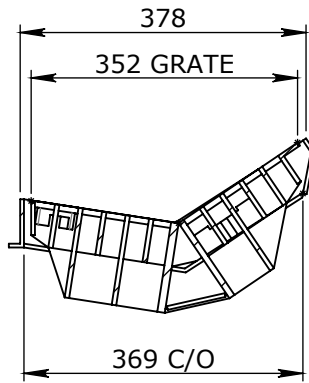

SECTION C-C

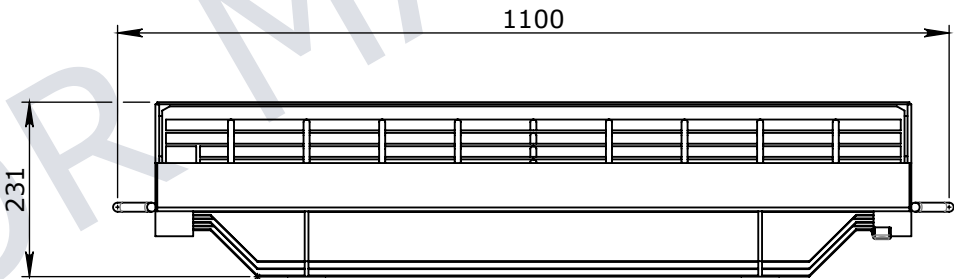

ELEVATION VIEW

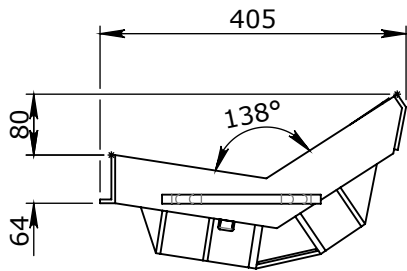

END VIEW

UNCONTROLLED DOCUMENT WHEN PRINTED

- 1. MATERIAL SPECIFICATIONS UNO  
SECTIONS & FLATS - AS 3679 - GR 300+  
PLATES AS 3678 - GR 250  
SHS AS 1163 - GR 350
- 2. WELDING TO COMPLY TO AS 1554.1 UNO

GENERAL TOLERANCES

NOMINAL SIZE	UP TO 150	ABOVE 150 UP TO 500	ABOVE 500	ANGULAR ∠ X.X±0°30'
TOL	±1.0	±2.0	±5.0	∠ X ± 1°

TOLERANCES - FABRICATION

LINEAR X.XX ± 0.02	FACES SQUARE ⊥ 0.05/100
LINEAR X.X ± 0.1	FACES PARALLEL// 0.05/100
LINEAR X. ± 0.25	FACES FLAT ▯ 0.05/100

REVISION CONTROL

ANGULAR ∠ X.X ± 0°30' DIA. CONC WITHIN Ⓞ 0.05 TIR
ANGULAR ∠ X ± 1° EDGES CHAMFERED 1.0 x 45°
GENERAL SURFACE FINISH Ra 3.2

CHK / APPR:

AC

DATE:

RPEQ DOCUMENT #:

WEIGHT:

Kg

MATERIAL:

SURFACE TREATMENT:

**Infrastructure  
Products Australia**  
A CRH COMPANY

HEAD OFFICE:  
1 REEVES COURT  
BREAKWATER, VIC 3219  
1800 065 356

ENGINEERING & DEVELOPMENT:  
91 STRADBROKE STREET  
HEATHWOOD, QLD 4110  
(07) 3714 0444

PART/PRODUCT #  
50202879

REINFORCEMENT COMPUTATION

QUOTE #

PIT #

ORDER #

ITEM TYPE

CLIENT

CUBIS SYSTEMS / AUS PITS

PROJECT DESC

CATALOGUE PRODUCTS

DRAWING NAME

GRATE AND FRAME GMS 900X362 SM2 BOLTDOWN WITH STAINLESS STEEL CAP HEADS M10X50 CLASS D (G93GSM2)

DRAWING #

50202879

PAGE

1 / 1

SHEET SIZE

A3

SCALE

1:10

REV.

0