

CONCRETE PRODUCT NOTE:

1. REFER TO GENERAL TOLERANCES UNO
2. 40MPA FIBER REINFORCED CONCRETE (FIBERCON MP47@5KG/M³)
3. ALL LIFTING POINTS TO BE USED WHEN LIFTING
4. MINIMUM STRENGTH OF CONCRETE SHALL BE 25MPA AT THE TIME OF LIFTING
5. COVER TO REINFORCEMENT TO BE 50mm
6. REFER TO ANCON LIFTING ARRANGEMENT PLAN
7. CONCRETE VOLUME M³ - 0.13

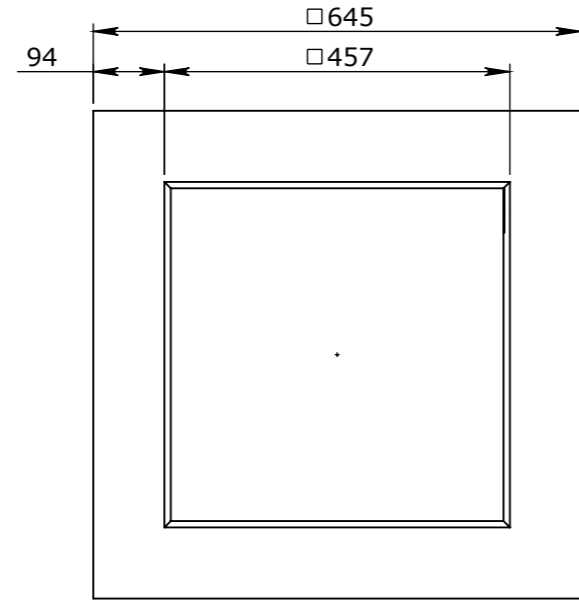

PLAN VIEW

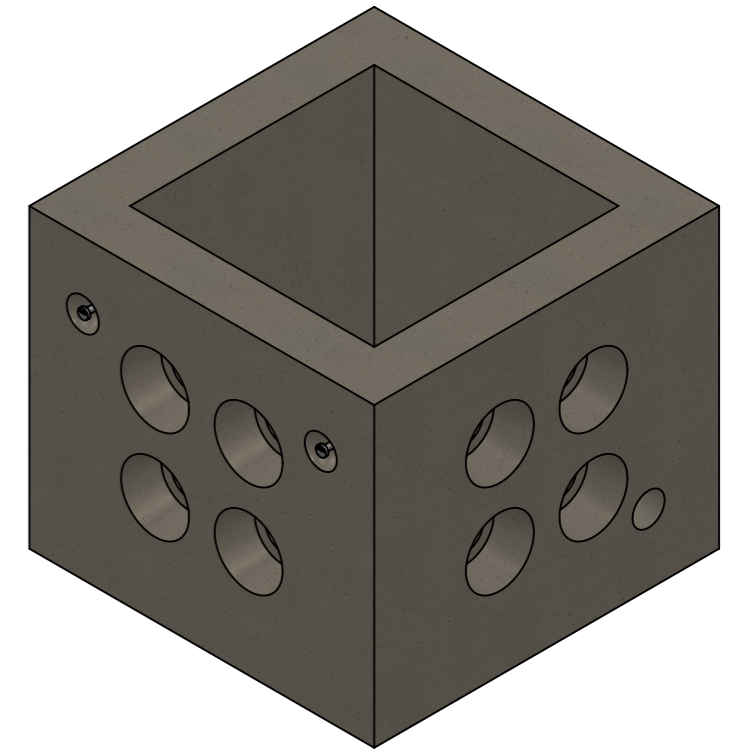

ISOMETRIC VIEW

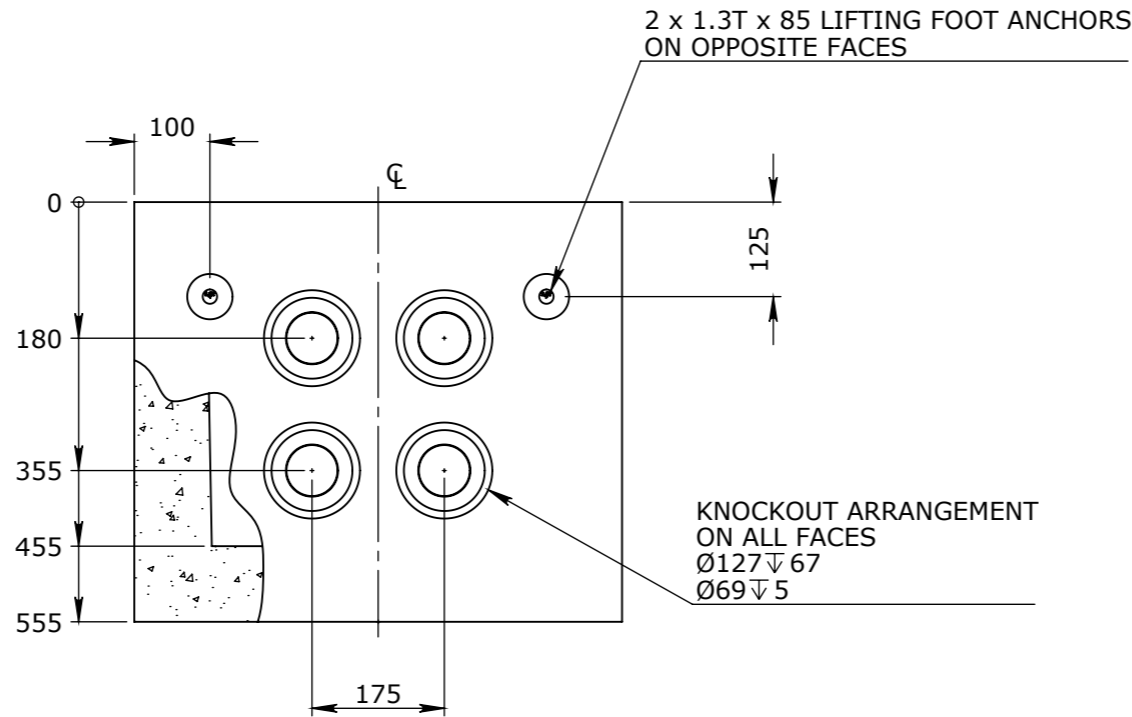

ELEVATION VIEW

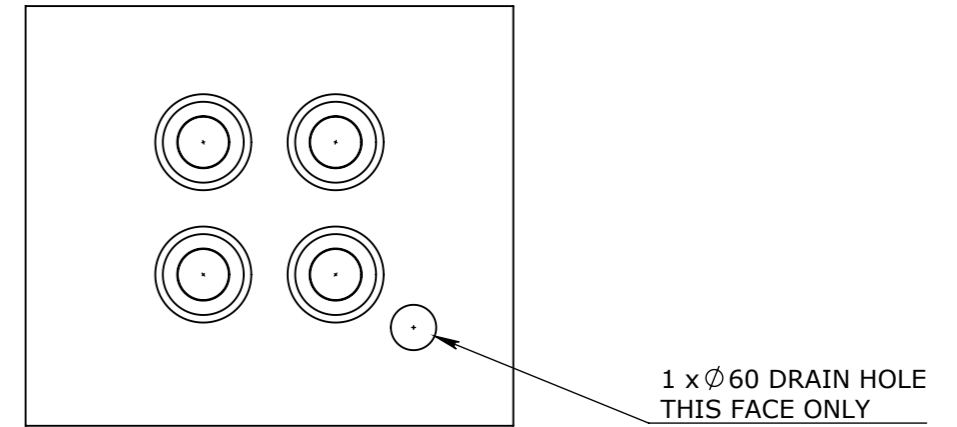

END VIEW

ISSUED FOR CONSTRUCTION

- TOLERANCE NOTES:**
1. CONCRETE TOLERANCES TO BE INCONJUNCTION / ACCORDANCE WITH AS3600 - CONCRETE STRUCTURES
 2. WHEN A BROOME FINISH IS REQUIRED THE GENERAL TOLERANCE SUPERCEEDS THE FLATNESS TOLERANCE
 3. WALL THICKNESS - DIMENSION AS NOTED IS MINIMUM THICKNESS ONLY
 4. CONCRETE GRADE - 40MPA UNLESS NOTED OTHERWISE
 5. DIMENSIONS ARE NOT INCLUSIVE OF SEALANTS OF JOINTS
 6. SURFACE FINISH - CLASS 4 (AS3610.1)

Rev	DESCRIPTION	DATE	BY	APPROVED
3				
2				
1				

GENERAL TOLERANCES		REVISION CONTROL	
NOMINAL:	UP TO 1000mm	1M AND ABOVE	FLATNESS: (NOT INCLUDING BROOME FINISH)
TOLERANCE:	±5mm	1mm IN 200mm UP TO A MAXIMUM OF 20mm	±4mm PER 1M WIDTH IN 1M LENGTH

CHK / APPR:	C.All
DATE:	01/06/2018
RPEQ DOCUMENT #:	
WEIGHT:	312Kg
MATERIAL:	CONCRETE 40MPa



HEAD OFFICE:
CARNGHAM ROAD
BALLARAT, VIC 3351
(03) 5335 8741

ENGINEERING & DEVELOPMENT:
2 STRADBROKE STREET
HEATHWOOD, QLD 4110
(07) 3714 0444

DRAFTED DATE:	21-Feb-18
DRAFTED BY:	S.GAFFAR
DATE LAST SAVED:	01-Jun-18
LAST SAVED BY:	charlesa
DRAWN TO AS 1100	DO NOT SCALE FROM SHEET

PROJECT:	PIT CONCRETE 450x450x450x95mm CLASS D		
NAME:		REV	0
DRAWING No:	50201624		
PROJECT / CATALOGUE CODE:	50201624	PAGE:	1 / 1
		SHEET:	A3
		SCALE UNO:	1:10