

CONCRETE PRODUCT NOTE:

- REFER TO GENERAL TOLERANCES UNO
- GRADE OF CONCRETE - 40MPA
- ALL LIFTING POINTS TO BE USED WHEN LIFTING
- MINIMUM STRENGTH OF CONCRETE SHALL BE 25MPA AT THE TIME OF LIFTING
- COVER TO REINFORCEMENT TO BE 50mm
- REFER TO ANCON LIFTING ARRANGEMENT PLAN

BOM:50204870_ENCASEMENT 800x800x200 TO SUIT C5 SL2 CLASS D

ITEM #	QTY.	PART#	DESCRIPTION	MATERIAL	VOLUME
1	1	50201265	CONCRETE 40MPA	CONCRETE 40MPa	0.1
2	3	50201105	FERRULE ZP M12x50 WITH 65x50 REO	MIXED REINFORCEMENT STEEL	
3	3	50201048	FERRULE ZP M12x50 C/W 10mm HOLE	MS GR250 ZINC	
4	3	50202447	CATCH BOX SL2	MS GR-250 GALV	
5	4	50201274	FOOT ANCHOR ZP 1.3Tx65mm	MS GR-250 GALV	

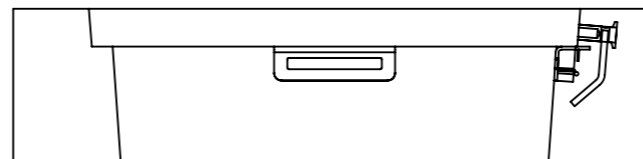
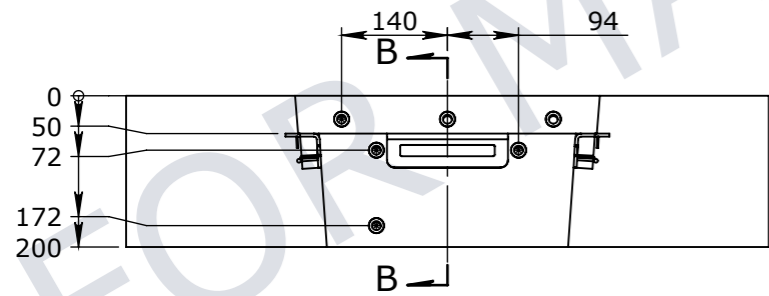
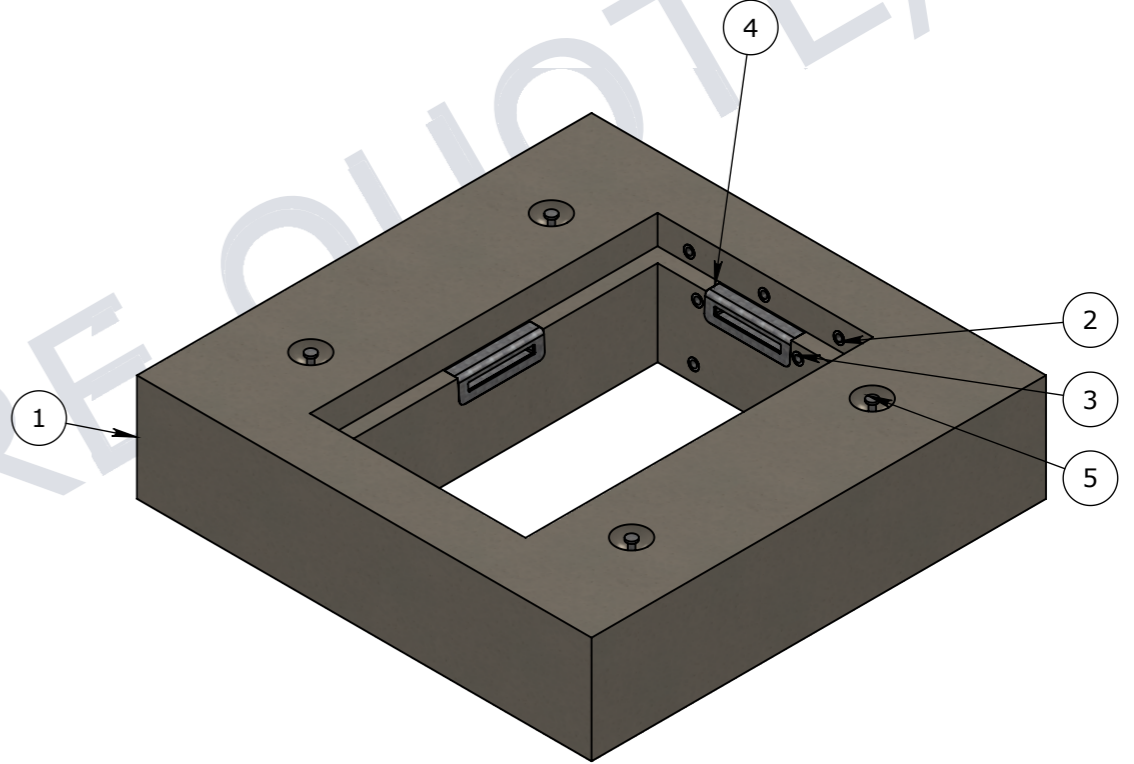
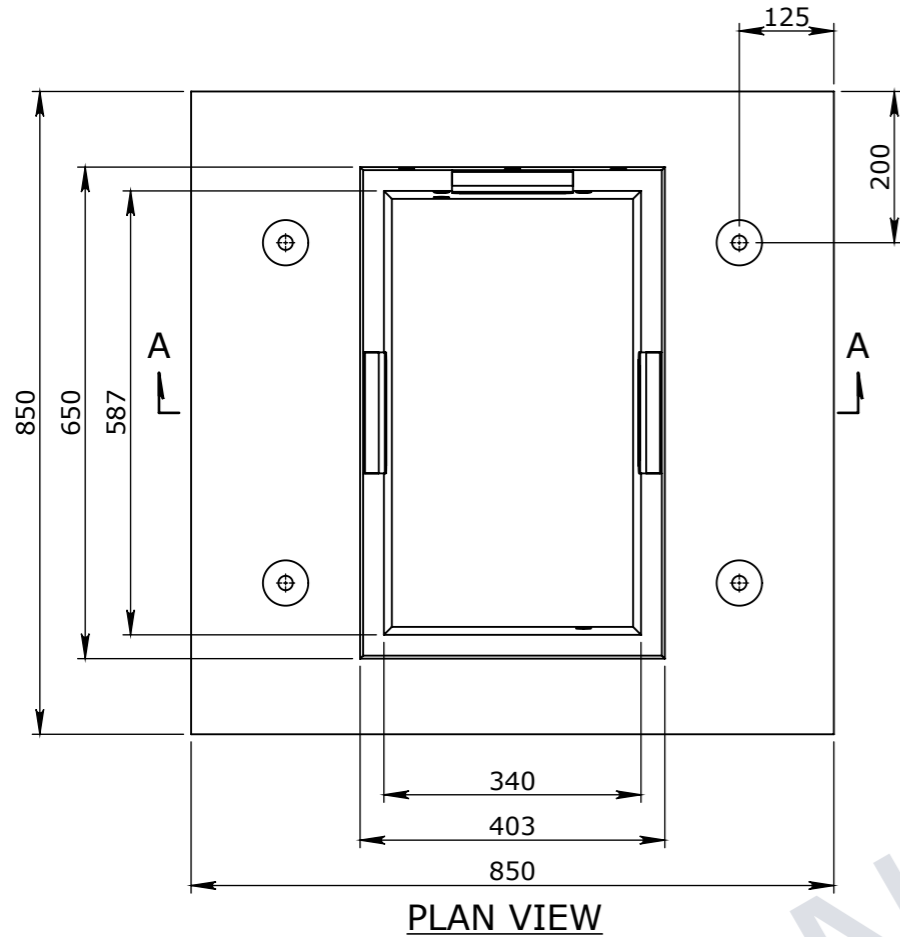

UNCONTROLLED DOCUMENT WHEN PRINTED

- TOLERANCE NOTES:**
- CONCRETE TOLERANCES TO BE IN CONJUNCTION / ACCORDANCE WITH AS3600 - CONCRETE STRUCTURES
 - WHEN A BROOME FINISH IS REQUIRED THE GENERAL TOLERANCE SUPERCEEDS THE FLATNESS TOLERANCE
 - WALL THICKNESS - DIMENSION AS NOTED IS MINIMUM THICKNESS ONLY
 - CONCRETE GRADE - 40MPA UNLESS NOTED OTHERWISE
 - DIMENSIONS ARE NOT INCLUSIVE OF SEALANTS OF JOINTS
 - SURFACE FINISH - CLASS 4 (AS3610.1)

Rev	DESCRIPTION	DATE	BY	APPROVED
3				
2				
1				

GENERAL TOLERANCES		REVISION CONTROL	
NOMINAL:	UP TO 1000mm	1M AND ABOVE	FLATNESS: (NOT INCLUDING BROOME FINISH)
TOLERANCE:	±5mm	1mm IN 200mm UP TO A MAXIMUM OF 20mm	±4mm PER 1M WIDTH IN 1M LENGTH

CHK / APPR:	M.LEE
DATE:	
RPEQ DOCUMENT #:	
WEIGHT:	251.47Kg
MATERIAL:	CONCRETE 40MPA
IRF REF:	

CUBIS SYSTEMS
A CRH COMPANY

HEAD OFFICE:
CARNGHAM ROAD
BALLARAT, VIC 3351
(03) 5335 8741

ENGINEERING & DEVELOPMENT:
91 STRADBROKE STREET
HEATHWOOD, QLD 4110
(07) 3714 0444

THE INFORMATION DISCLOSED IN THIS DOCUMENT IS CONFIDENTIAL AND IS NOT WITHOUT THE EXPRESS CONSENT OF CUBIS SYSTEMS

AUSTRALIA TO BE COPIED, REPRODUCED, OR GIVEN TO ANY OTHER PARTY IN ANY FORM AND THAT ALL COPYRIGHT, DESIGNS AND PATENTS VEST IN CUBIS SYSTEMS AUS.

DRAFTED DATE:	16/12/2020
DRAFTED BY:	
DATE LAST SAVED:	16/12/2020
LAST SAVED BY:	MLEE
DRAWN TO AS 1100 DO NOT SCALE FROM SHEET	

PART/PRODUCT #	50204870	QUOTE #		ORDER #	
REINFORCEMENT COMPUTATION		PIT #		ITEM TYPE	
CLIENT	CUBIS SYSTEMS/AUSPITS				
PROJECT DESC	ENCASEMENT 800x800x200 TO SUIT C5 SL2 CLASS D				
DRAWING NAME	800x800x200 ENCASEMENT				
DRAWING #	50204870	PAGE	1 / 1	SHEET SIZE	A3
SCALE	1:10	REV.	0		