

BOM:50201858

ITEM #	PART #	DESCRIPTION	WEIGHT
1	50201858	AX S™ COVER GMS TO SUIT 600X600 OPENING NON REBATE CLASS B	31.33

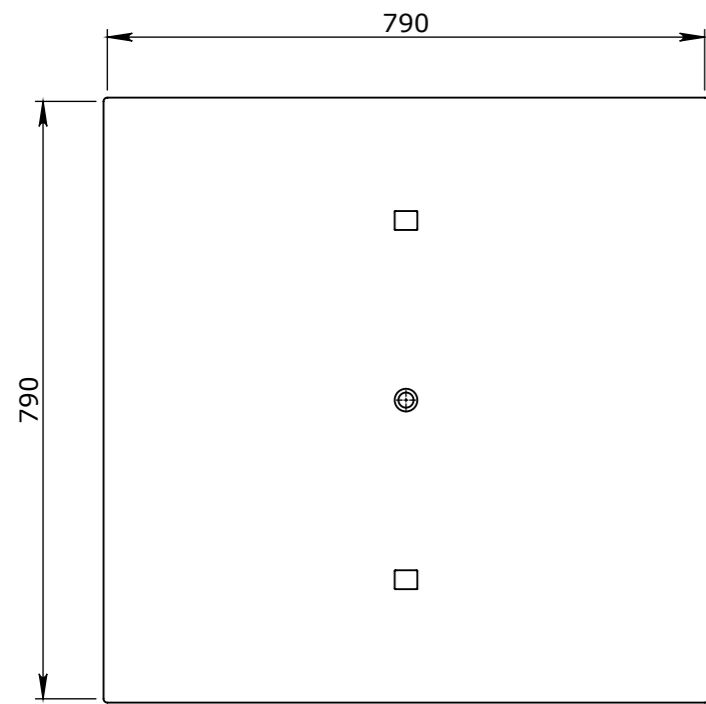

PLAN VIEW



ELEVATION VIEW

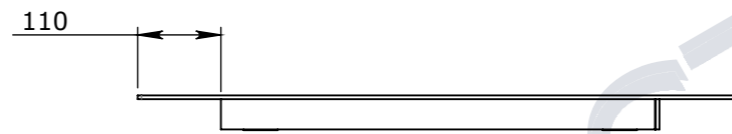

END VIEW

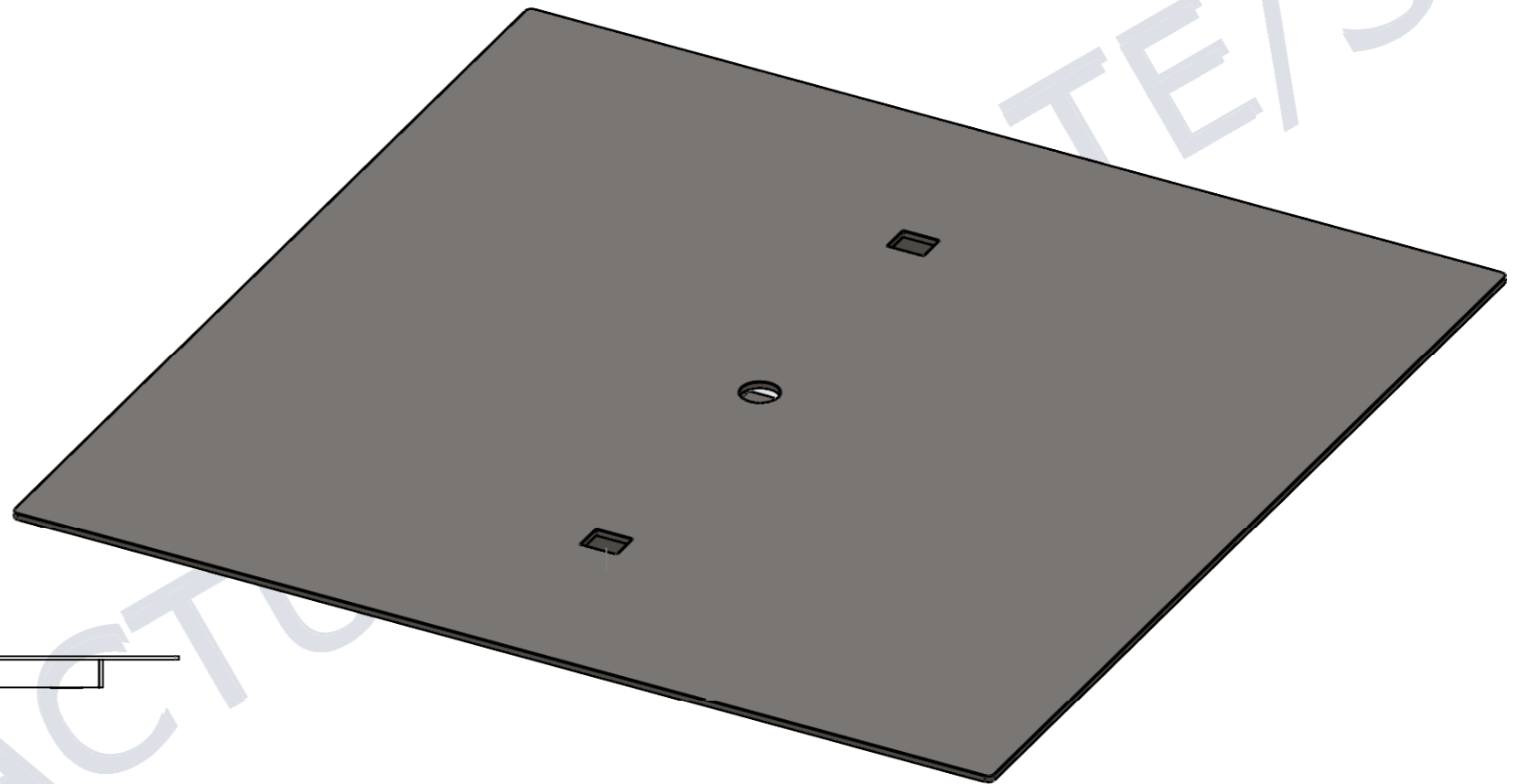

ISOMETRIC VIEW
SCALE 1:5

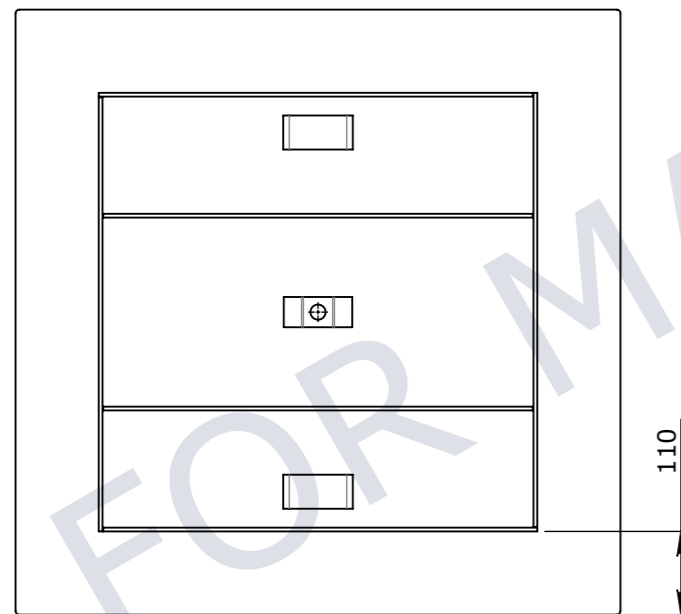

BOTTOM VIEW

- FABRICATION NOTE:**
1. REFER TO TOLERANCES - FABRICATION UNO
 2. WELDS TO COMPLY WITH AS 1554-1
 3. REMOVE ALL BURRS & SHARP EDGES
 4. HOT DIP GALVANIZED AFTER FABRICATING ACCORDING TO AS4680

UNCONTROLLED DOCUMENT WHEN PRINTED

TOLERANCE NOTES:

1. CONCRETE TOLERANCES TO BE INCONJUNCTION / ACCORDANCE WITH AS3600 - CONCRETE STRUCTURES
2. WHEN A BROOM FINISH IS REQUIRED THE GENERAL TOLERANCE SUPERCEDES THE FLATNESS TOLERANCE
3. WALL THICKNESS - DIMENSION AS NOTED IS MINIMUM THICKNESS ONLY
4. CONCRETE GRADE - 40MPA UNLESS NOTED OTHERWISE
5. DIMENSIONS ARE NOT INCLUSIVE OF SEALANTS OF JOINTS
6. SURFACE FINISH - CLASS 4 (AS3610.1)

Rev	DESCRIPTION	DATE	BY	APPROVED
3				
2				
1				

GENERAL TOLERANCES		REVISION CONTROL	
NOMINAL:	UP TO 1000mm	1M AND ABOVE	FLATNESS: (NOT INCLUDING BROOME FINISH)
TOLERANCE:	±5mm	1mm IN 200mm UP TO A MAXIMUM OF 20mm	±4mm PER 1M WIDTH IN 1M LENGTH

CHK / APPR:	AC
DATE:	
RPEQ DOCUMENT #:	
WEIGHT:	31.33Kg
MATERIAL:	MS GR-250
IRF REF:	

Infrastructure Products Australia
A CRH COMPANY

HEAD OFFICE:
1 REEVES COURT
BREAKWATER, VIC 3219
1800 065 356

ENGINEERING & DEVELOPMENT:
91 STRADBROKE STREET
HEATHWOOD, QLD 4110
(07) 3714 0444

DRAFTED DATE:	22/08/2022
DRAFTED BY:	
DATE LAST SAVED:	2/09/2022
LAST SAVED BY:	CABEYSINGH
DRAWN TO AS 1100	DO NOT SCALE FROM SHEET

PART/PRODUCT #	50201858	QUOTE #		ORDER #	
REINFORCEMENT COMPUTATION		PIT #		ITEM TYPE	
CLIENT	CUBIS SYSTEMS/AUSPITS				
PROJECT DESC	AX S™ COVER GMS TO SUIT 600x600 OPENING NON REBATE CLASS B				
DRAWING NAME		DRAWING #	50201858	PAGE	1 / 1
		SHEET SIZE	A3	SCALE	1:10
				REV.	0