

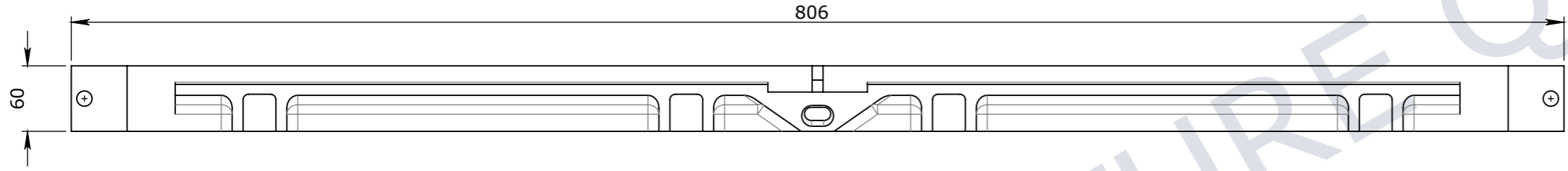

**ISOMETRIC VIEW**  
SCALE 1:10

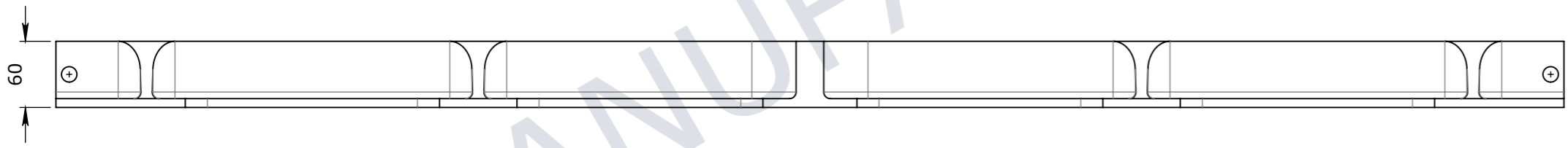

**PLAN VIEW**



**ELEVATION VIEW**

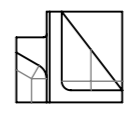

**END VIEW**

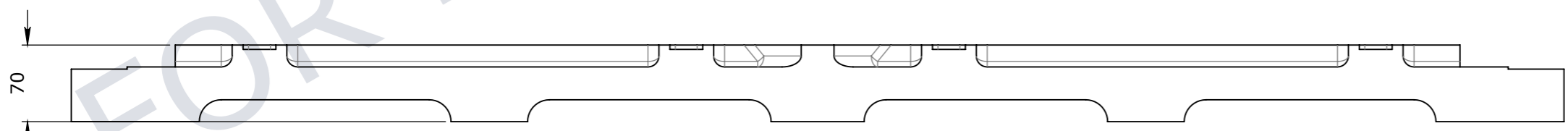

**BOTTOM VIEW**

UNCONTROLLED DOCUMENT WHEN PRINTED

- MATERIAL SPECIFICATIONS UNO SECTIONS & FLATS - AS 3679 - GR 300+ PLATES AS 3678 - GR 250 SHS AS 1163 - GR 350
- WELDING TO COMPLY TO AS 1554.1 UNO

Rev	DESCRIPTION	DATE:	BY:	ECO#:

CHK / APPR:	LEE, MIA
DATE:	
RPEQ DOCUMENT #:	



HEAD OFFICE:  
CARNINGHAM ROAD  
BALLARAT, VIC 3351  
(03) 5335 8741

ENGINEERING & DEVELOPMENT:  
2 STRADBROKE STREET  
HEATHWOOD, QLD 4110  
(07) 3714 0444

PROJECT DESCRIPTION:  
**CUBIS SYSTEMS AUSTRALIA CATALOGUE PRODUCTS**

DRAWING NAME:  
**ASSEMBLY MANHOLE FRAME, LONG SIDE**

GENERAL TOLERANCES				
NOMINAL SIZE	UP TO 150	ABOVE 150 UP TO 500	ABOVE 500	ANGULAR $\angle X.X \pm 0^{\circ}30'$
TOL	$\pm 1.0$	$\pm 2.0$	$\pm 5.0$	$\angle X \pm 1^{\circ}$

TOLERANCES - FABRICATION		
LINEAR X.XX $\pm 0.02$	FACES SQUARE $\perp 0.05/100$	ANGULAR $\angle X.X \pm 0^{\circ}30'$ DIA. CONC WITHIN $\odot 0.05$ TIR
LINEAR X.X $\pm 0.1$	FACES PARALLEL $\parallel 0.05/100$	ANGULAR $\angle X \pm 1^{\circ}$ EDGES CHAMFERED 1.0 x 45°
LINEAR X. $\pm 0.25$	FACES FLAT $\nabla 0.05/100$	GENERAL SURFACE FINISH Ra $\sqrt{3.2}$

REVISION CONTROL	

WEIGHT:	12.93Kg
MATERIAL:	Malleable Cast Iron
SURFACE TREATMENT:	

THE INFORMATION DISCLOSED IN THIS DOCUMENT IS CONFIDENTIAL AND IS NOT WITHOUT THE EXPRESS CONSENT OF CUBIS SYSTEMS AUSTRALIA TO BE COPIED, REPRODUCED, OR GIVEN TO ANY OTHER PARTY IN ANY FORM AND THAT ALL COPYRIGHT, DESIGNS AND PATENTS VEST IN CUBIS SYSTEMS AUS.

DRAWN TO AS 1100 DO NOT SCALE FROM SHEET	DRAWING No: <b>50201863</b>	REV: <b>1</b>
SHEET: <b>A3</b>	PAGE: <b>1/1</b>	SCALE UNO: <b>1:5</b>
DRAFTED DATE: <b>28/02/2019</b>	DRAFTED BY:	