

BILL OF MATERIALS

ITEM No.	PART No	DESCRIPTION
1	50203801-01	MAIN BODY
2	50203801-02	INNER BARREL
3	50203801-04	LOCK BRACKET
4	50203801-06	DUST BOOT
5	50203801-05	SPRING
6	50203801-07	M5x0.8x8 SOCKET HEAD CAP SCREW
7	50203801-03	M22 NUT

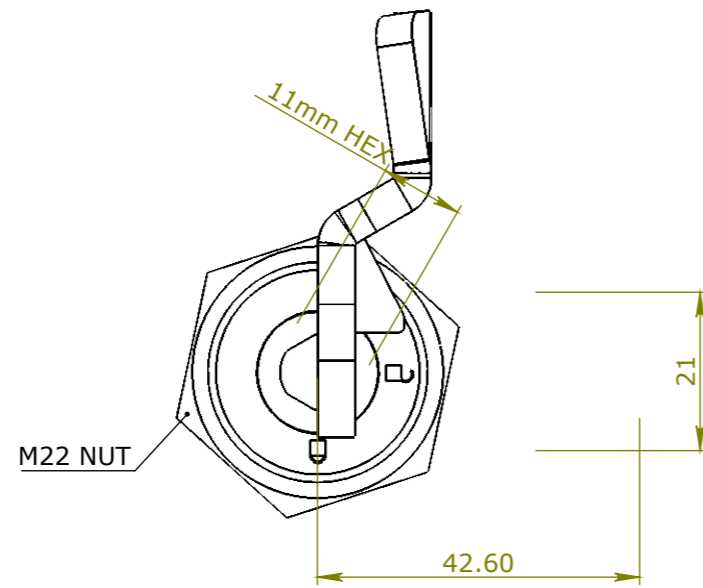

PLAN VIEW
DUST BOOT REMOVED FOR CLARITY

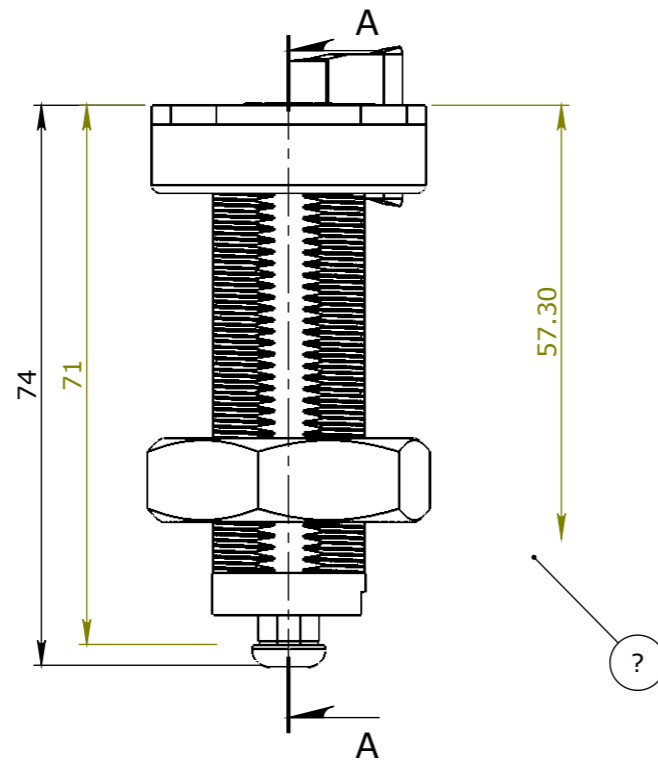

ELEVATION VIEW

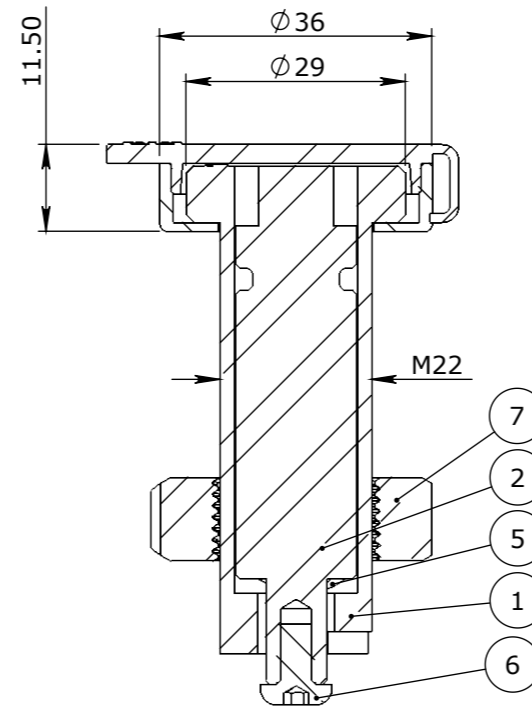

SECTION A-A

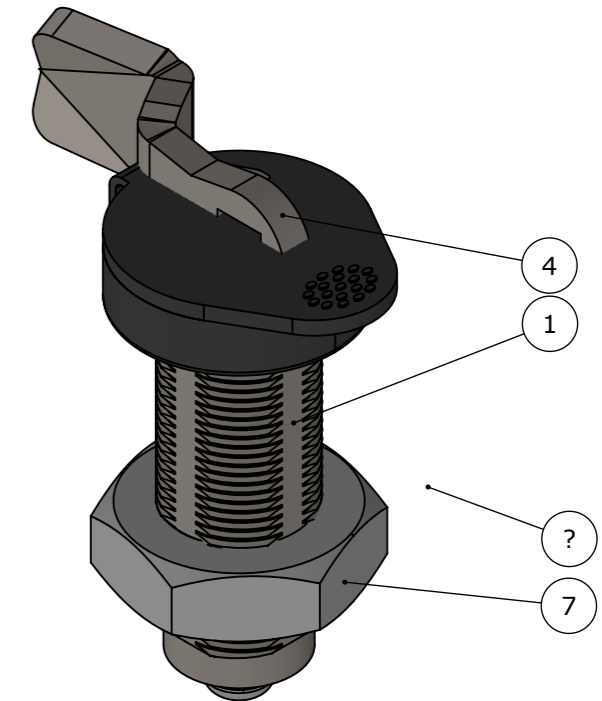

ISOMETRIC VIEW

- MATERIAL SPECIFICATIONS UNO SECTIONS & FLATS - AS 3679 - GR 300+ PLATES AS 3678 - GR 250 SHS AS 1163 - GR 350
- WELDING TO COMPLY TO AS 1554.1 UNO

Rev	DESCRIPTION	DATE	BY	APPROVED
3				
2				
1				

CHK / APPR: CA
DATE: 28/11/2018
RPEQ DOCUMENT #:

HEAD OFFICE:
CARNINGHAM ROAD
BALLARAT, VIC 3351
(03) 5335 8741

ENGINEERING & DEVELOPMENT:
2 STRADBROKE STREET
HEATHWOOD, QLD 4110
(07) 3714 0444

DRAFTED DATE: 17/08/2018
DRAFTED BY:
DATE LAST SAVED: 27/07/2020
LAST SAVED BY: cAbeyasinghe
DRAWN TO AS 1100
DO NOT SCALE FROM SHEET

PROJECT: CUBIS SYSTEMS CATALOGUE PRODUCTS COMPOSITE COVERS, LOCK

NAME: LOCK KEYED TO SUIT COMPOSITE COVERS

REV: 0

SCALE UNO: 1:1

SHEET: 1/1 A3

GENERAL TOLERANCES				
NOMINAL SIZE	UP TO 150	ABOVE 150 UP TO 500	ABOVE 500	ANGULAR $\angle X.X \pm 0^{\circ}30'$
TOL	± 1.0	± 2.0	± 5.0	$\angle X \pm 1^{\circ}$

TOLERANCES - FABRICATION		
LINEAR X.XX ± 0.02	FACES SQUARE $\perp 0.05/100$	ANGULAR $\angle X.X \pm 0^{\circ}30'$ DIA. CONC WITHIN $\odot 0.05$ TIR
LINEAR X.X ± 0.1	FACES PARALLEL $\parallel 0.05/100$	ANGULAR $\angle X \pm 1^{\circ}$ EDGES CHAMFERED 1.0 x 45°
LINEAR X. ± 0.25	FACES FLAT $\square 0.05/100$	GENERAL SURFACE FINISH $Ra \sqrt{3.2}$

REVISION CONTROL		
LINEAR X.XX ± 0.02	FACES SQUARE $\perp 0.05/100$	ANGULAR $\angle X.X \pm 0^{\circ}30'$ DIA. CONC WITHIN $\odot 0.05$ TIR
LINEAR X.X ± 0.1	FACES PARALLEL $\parallel 0.05/100$	ANGULAR $\angle X \pm 1^{\circ}$ EDGES CHAMFERED 1.0 x 45°
LINEAR X. ± 0.25	FACES FLAT $\square 0.05/100$	GENERAL SURFACE FINISH $Ra \sqrt{3.2}$

WEIGHT: 0Kg
MATERIAL: Material <not specified>
SURFACE TREATMENT:

NOTION DISCLOSED IN THIS DOCUMENT IS CONFIDENTIAL AND IS NOT WITHOUT THE EXPRESS CONSENT OF CUBIS SYSTEMS AUSTRALIA TO BE COPIED, REPRODUCED, OR GIVEN TO ANY OTHER PARTY IN ANY FORM AND THAT ALL COPYRIGHT, DESIGNS AND PATENTS VEST IN CUBIS SYSTEMS AUS.