

BOM:50201248 PRO

ITEM #	QTY.	PART #	DESCRIPTION	WEIGHT
1	1	50201248	POWDER MICROTUFF RECLAIM BLACK	4.9

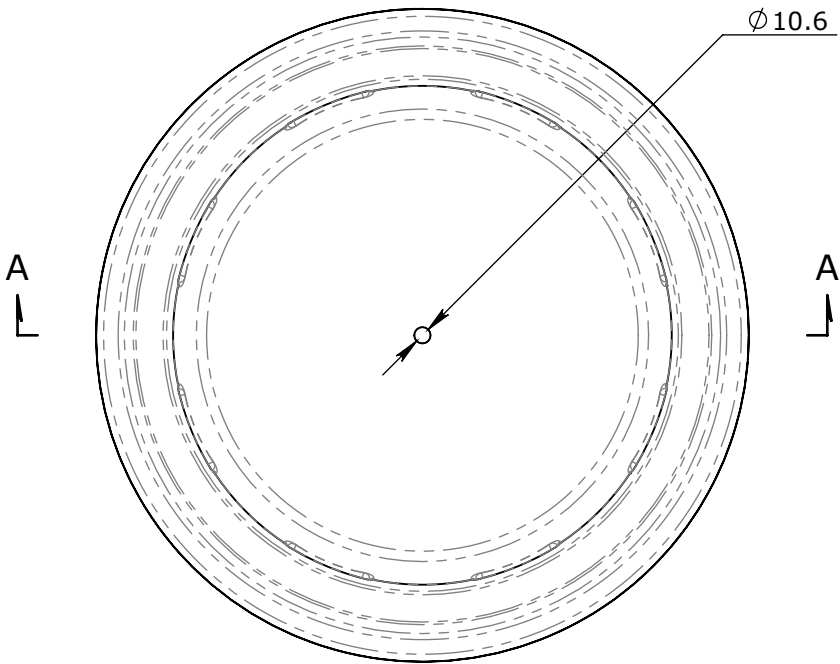

PLAN VIEW

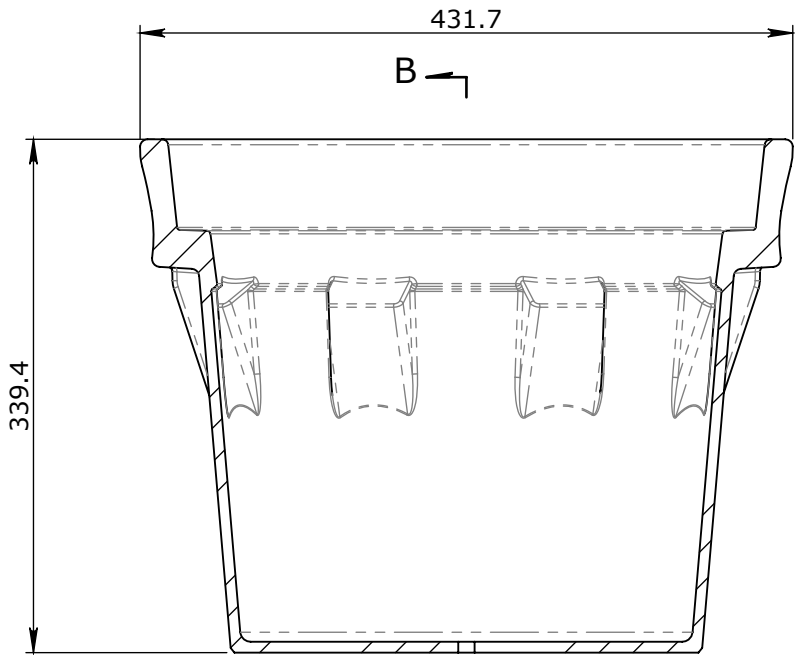

SECTION A-A

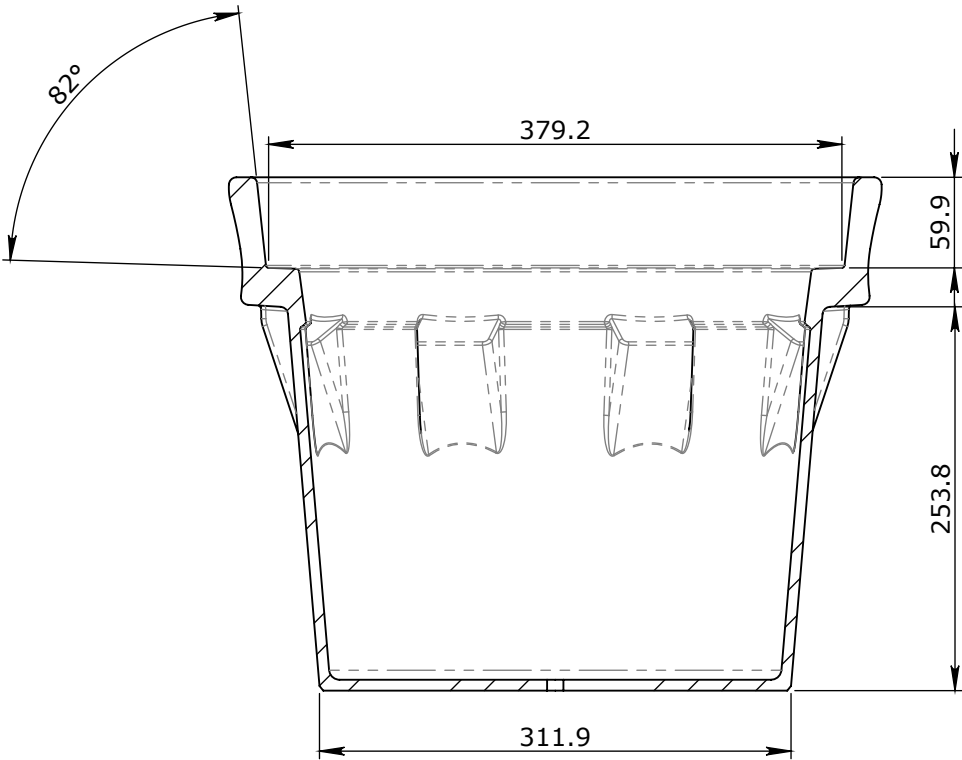

SECTION B-B

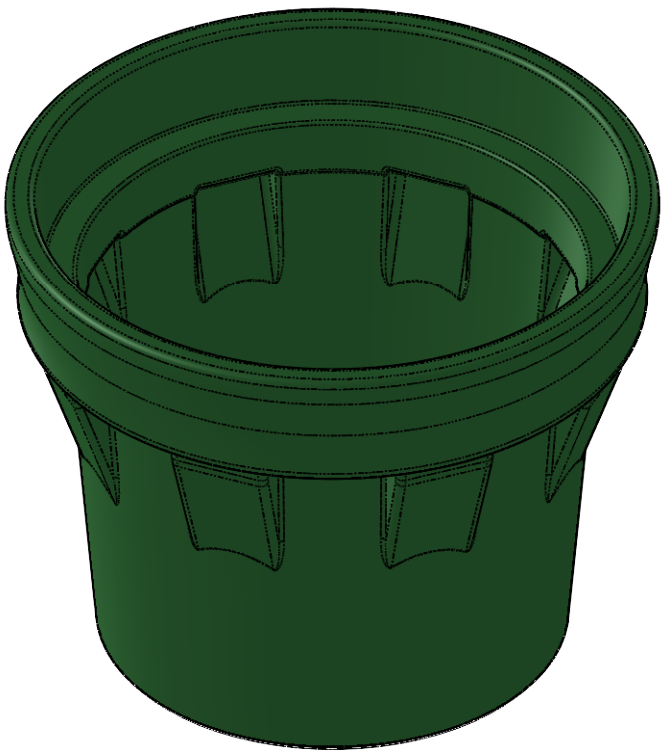

ISOMETRIC VIEW

UNCONTROLLED DOCUMENT WHEN PRINTED

- TOLERANCE NOTES:**
1. CONCRETE TOLERANCES TO BE INCONJUNCTION / ACCORDANCE WITH AS3600 - CONCRETE STRUCTURES
 2. WHEN A BROOME FINISH IS REQUIRED THE GENERAL TOLERANCE SUPERCEEDS THE FLATNESS TOLERANCE
 3. WALL THICKNESS - DIMENSION AS NOTED IS MINIMUM THICKNESS ONLY
 4. CONCRETE GRADE - 40MPA UNLESS NOTED OTHERWISE
 5. DIMENSIONS ARE NOT INCLUSIVE OF SEALANTS OF JOINTS
 6. SURFACE FINISH - CLASS 4 (AS3610.1)

3				
2				
1				
Rev.	DESCRIPTION	DATE	BY	APPROVED
GENERAL TOLERANCES		REVISION CONTROL		
NOMINAL:	UP TO 1000mm	1M AND ABOVE	FLATNESS: (NOT INCLUDING BROOME FINISH)	
TOLERANCE:	±5mm	1mm IN 200mm UP TO A MAXIMUM OF 20mm	±4mm PER 1M WIDTH IN 1M LENGTH	

CHK / APPR:	
DATE:	
RPEQ DOCUMENT #:	
WEIGHT:	4.9Kg
MATERIAL:	BVCI HDPE (PLASTIC)
IRF REF:	



HEAD OFFICE:
CARNGHAM ROAD
BALLARAT, VIC 3351
(03) 5335 8741
ENGINEERING & DEVELOPMENT:
91 STRADBROKE STREET
HEATHWOOD, QLD 4110
(07) 3714 0444
THE INFORMATION DISCLOSED IN THIS DOCUMENT IS CONFIDENTIAL AND IS NOT WITHOUT THE EXPRESS CONSENT OF CUBIS SYSTEMS
AUSTRALIA TO BE COPIED,REPRODUCED, OR GIVEN TO ANY OTHER PARTY IN ANY FORM AND THAT ALL COPYRIGHT, DESIGNS AND PATENTS VEST IN CUBIS SYSTEMS AUS.

DRAFTED DATE:	10/08/2021
DRAFTED BY:	P.ADAMS
DATE LAST SAVED:	20/08/2021
LAST SAVED BY:	NBRADIC
DRAWN TO AS 1100	DO NOT SCALE FROM SHEET

ISSUE		DATE	CLIENT APPROVAL	
B		18/01/2022		
PART/PRODUCT #			QUOTE #	ORDER #
50201248				
REINFORCEMENT COMPUTATION			PIT #	ITEM TYPE
CLIENT				
PROJECT DESC				
DRAWING NAME				REV.
50201248 - MONObox™ ELECTRICAL DISTRIBUTION DIA390x340				
DRAWING #		PAGE	SHEET SIZE	SCALE
50201248 PRO		1 / 1	A3	1:5
				B