

**C5 PIT WITH SL1 COVER**  
FOR CLARITY  
SCALE 1:20

BILL OF MATERIALS - 50201227			
ITEM #	QTY.	PART #	EPICORE DESCRIPTION
1	1	50201227-01	AX S™ SCEC SL1 C5 COVER LID WELDMENT
2	1	50201227-02	AX S™ SCEC SL1 C5 HINGE WELDMENT
3	3	50201227-03	AX S™ SCEC SL1 C5 HINGE PIVOT PIN
4	1	50201227-04	AX S™ SCEC SL1 C5 LOCKING ARM 1
5	1	50201227-05	AX S™ SCEC SL1 C5 LOCKING ARM 2
6	1	1935301	PLATE ROTATING SCEC SL1
7	1	1935302	PIN HATCH PIVOT SCEC SL1
8	2	1935303	SPRING HATCH SCEC SL1
9	4	1935304	SCEC LIDS CAST HINGE
10	1	1935305	WELDMENT HATCH SCEC SL1
11	1	1935306	HANDLE SCEC
12	3		BOLT HEX ZP M10x35 CLASS 4.6
13	2		WASHER FLAT ZP M8
14	6		WASHER FLAT ZP M10
15	2		NYLOCK NUT ZP - M8
16	3		NYLOCK NUT ZP - M10
17	1	50201227-06	SL1 -C5 - GMS NAME PLATE

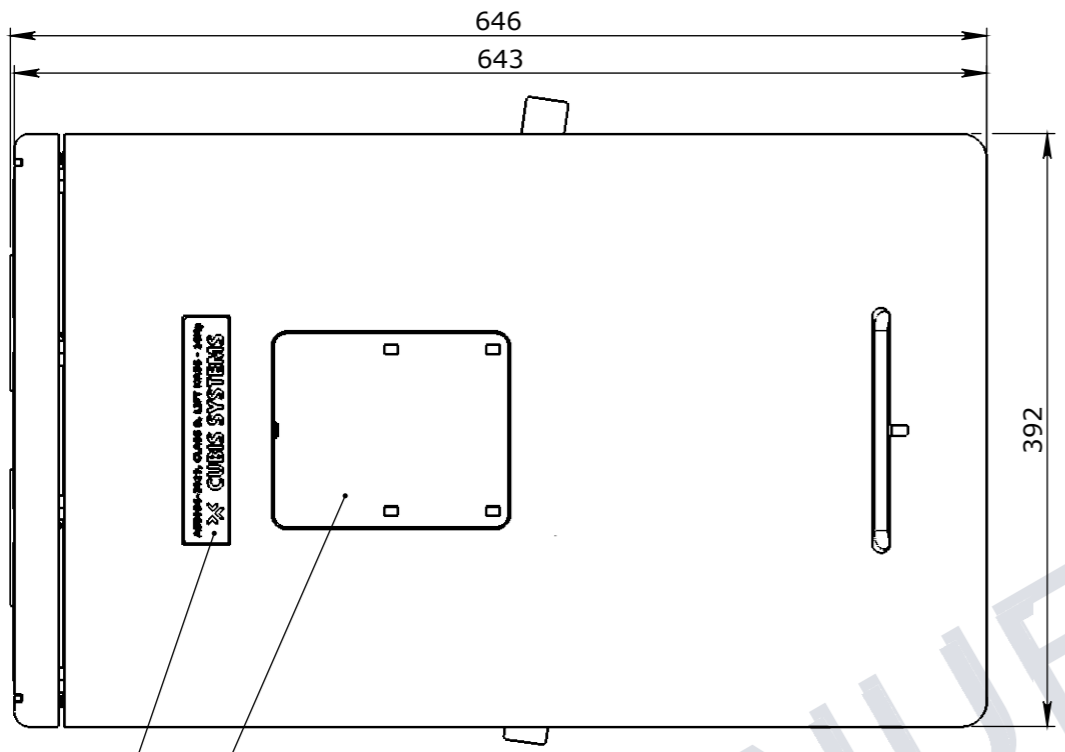

PLAN VIEW

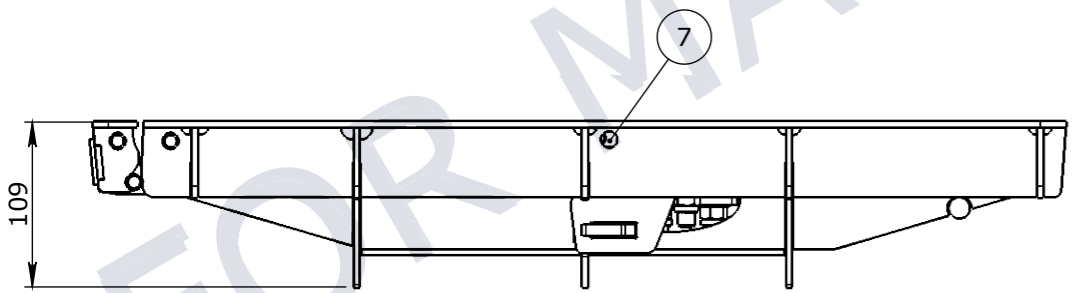

ELEVATION VIEW

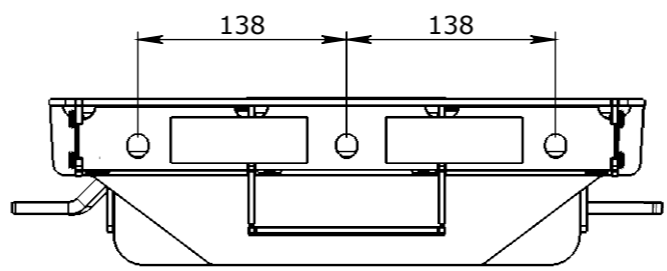

END VIEW

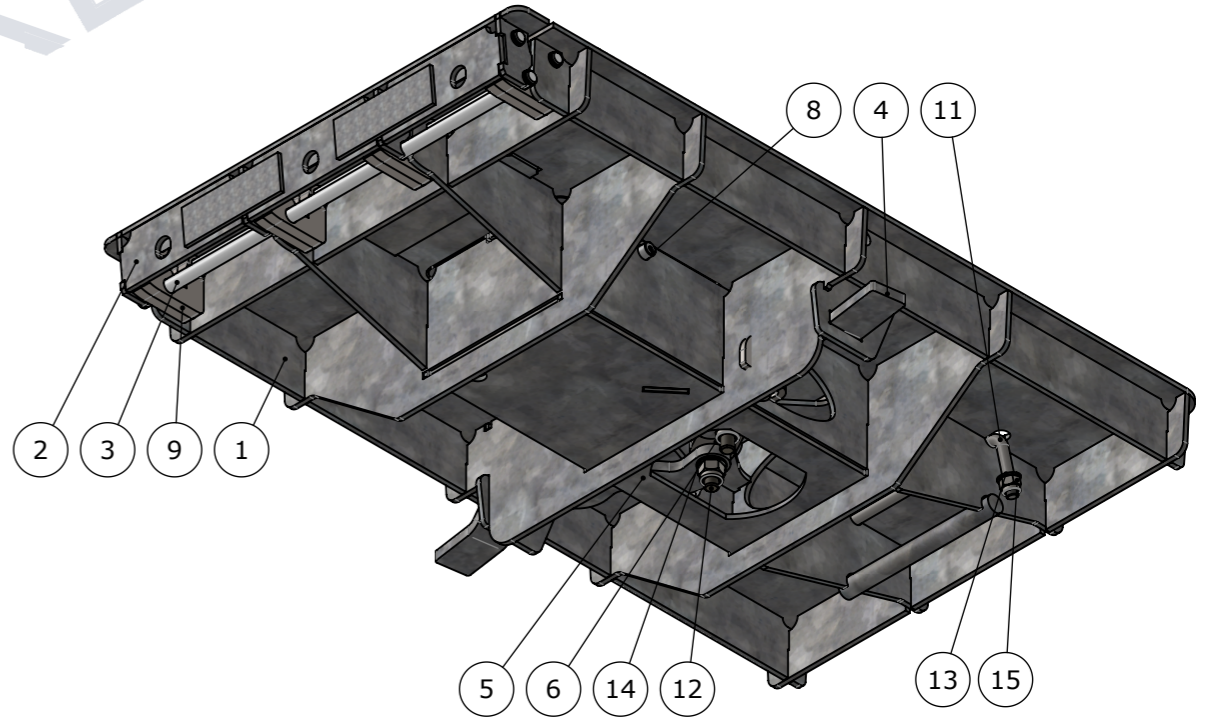

ISOMETRIC VIEW  
UNDERSIDE VIEW SHOWN FOR CLARITY

UNCONTROLLED DOCUMENT WHEN PRINTED

- 1. MATERIAL SPECIFICATIONS UNO SECTIONS & FLATS - AS 3679 - GR 300+ PLATES AS 3678 - GR 250 SHS AS 1163 - GR 350
- 2. WELDING TO COMPLY TO AS 1554.1 UNO

Rev	DESCRIPTION	DATE:	BY:	ECO#:

CHK / APPR:	CA
DATE:	
RPEQ DOCUMENT #:	



HEAD OFFICE:  
CARNINGHAM ROAD  
BALLARAT, VIC 3351  
(03) 5335 8741

ENGINEERING & DEVELOPMENT:  
2 STRADBROKE STREET  
HEATHWOOD, QLD 4110  
(07) 3714 0444

PROJECT DESCRIPTION:  
**CUBIS SYSTEMS AUSTRALIA  
CATALOGUE PRODUCTS**

GENERAL TOLERANCES				
NOMINAL SIZE	UP TO 150	ABOVE 150 UP TO 500	ABOVE 500	ANGULAR
TOL	±1.0	±2.0	±5.0	∠ X.X ± 0°30'

TOLERANCES - FABRICATION		
LINEAR X.XX ± 0.02	FACES SQUARE ⊥ 0.05/100	ANGULAR ∠ X.X ± 0°30' DIA. CONC WITHIN Ⓞ0.05 TIR
LINEAR X.X ± 0.1	FACES PARALLEL// 0.05/100	ANGULAR ∠ X ± 1° EDGES CHAMFERED 1.0 x 45°
LINEAR X. ± 0.25	FACES FLAT ▽ 0.05/100	GENERAL SURFACE FINISH Ra 3.2

REVISION CONTROL	

WEIGHT:	21Kg
MATERIAL:	
SURFACE TREATMENT:	

THE INFORMATION DISCLOSED IN THIS DOCUMENT IS CONFIDENTIAL AND IS NOT WITHOUT THE EXPRESS CONSENT OF CUBIS SYSTEMS AUSTRALIA TO BE COPIED, REPRODUCED, OR GIVEN TO ANY OTHER PARTY IN ANY FORM AND THAT ALL COPYRIGHT, DESIGNS AND PATENTS VEST IN CUBIS SYSTEMS AUS.

DRAWING NAME:		DRAWING No: <b>50201227</b>		REV: <b>0</b>
SHEET: <b>A3</b>	PAGE: <b>1/1</b>	SCALE UNO: <b>1:5</b>	DRAFTED DATE: <b>10/12/2018</b>	DRAFTED BY: