

BILL OF MATERIALS

ITEM #	QTY.	PART NUMBER	DESCRIPTION
1	1	50201203-01-01	LID 2, SCEC SL1 TO SUIT 1100x900 OPENING
2	2	50201203-01-02	HINGE, SCEC SL1 TO SUIT 1100x900 OPENING
3	1	50201203-02-01	COVER 2, COVER SCEC SL1 TO SUIT 1100x900 OPENING
4	1	50201203-03	LEFT HAND LOCKING BAR
5	1	50201203-04	RIGHT HAND LOCKING BAR
6	6	50201203-05	HINGE BAR, COVER SCEC SL1 TO SUIT 1100x900 OPENING
7	1	1935301	ROTATING PLATE & LOCKING PIN
8	1	1935302	PIN HATCH PIVOT SCEC SL1
9	2	1935303	HATCH DETENT
10	8	1935304	SCEC LIDS CAST HINGE
11	1	1935305	WELDMENT HATCH SCEC SL1
12	2	1935306	HANDLE SCEC
13	4		WASHER FLAT GALVANISED M8
14	4		NYLOCK NUT ZP - M8
15	3		BOLT HEX GALVANISED M10x30 CLASS 4.6
16	3		NYLOCK NUT ZP - M10
17	1	50201203-06	SL1 - 911 - GMS NAME PLATE

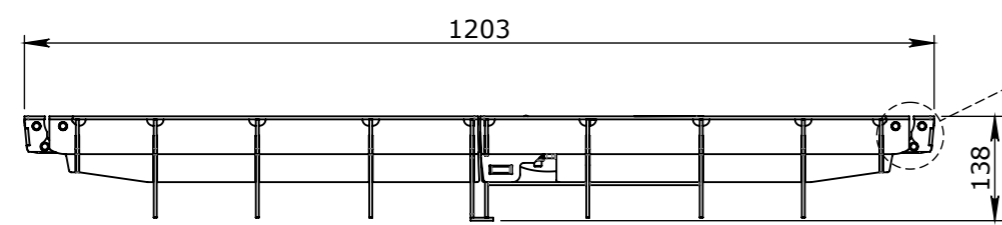

DETAIL A
SCALE 1:2

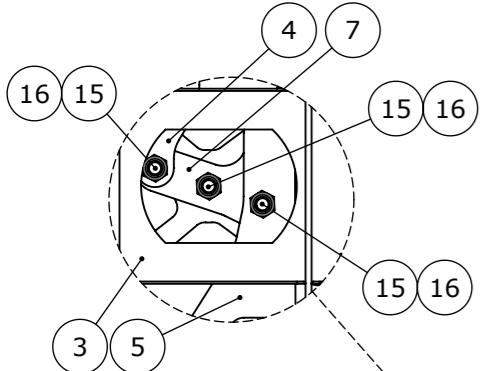

DETAIL B
SCALE 1:5

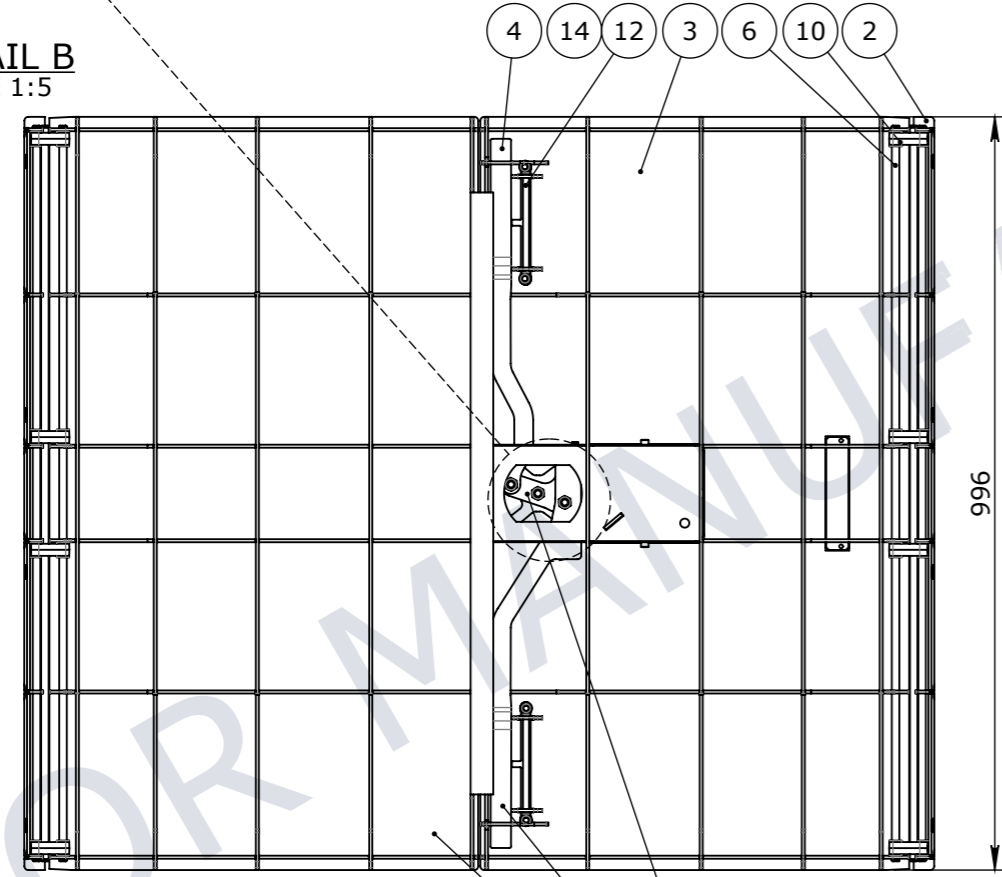

BOTTOM VIEW



DETAIL C
SCALE 1:2

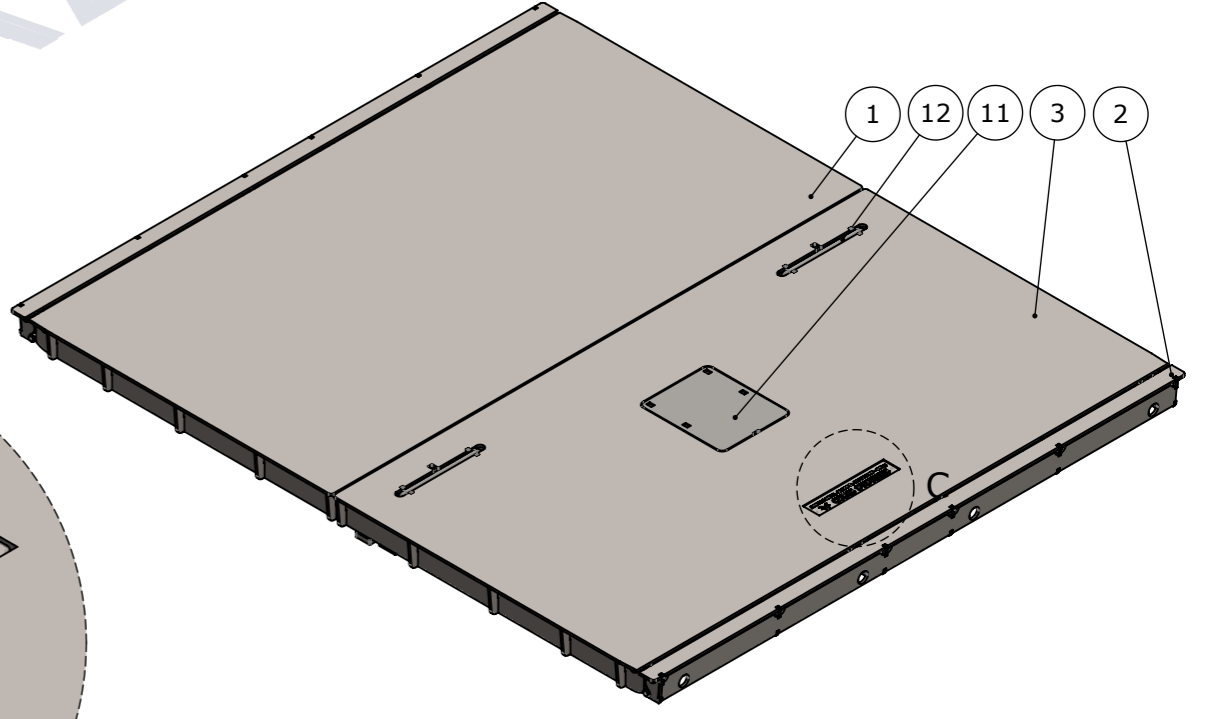

ISOMETRIC VIEW

UNCONTROLLED DOCUMENT WHEN PRINTED

- TOLERANCE NOTES:**
1. CONCRETE TOLERANCES TO BE IN CONJUNCTION / ACCORDANCE WITH AS3600 - CONCRETE STRUCTURES
 2. WHEN A BROOME FINISH IS REQUIRED THE GENERAL TOLERANCE SUPERCEEDS THE FLATNESS TOLERANCE
 3. WALL THICKNESS - DIMENSION AS NOTED IS MINIMUM THICKNESS ONLY
 4. CONCRETE GRADE - 40MPA UNLESS NOTED OTHERWISE
 5. DIMENSIONS ARE NOT INCLUSIVE OF SEALANTS OF JOINTS
 6. SURFACE FINISH - CLASS 4 (AS3610.1)

Rev	DESCRIPTION	DATE	BY	APPROVED
3				
2				
1				

GENERAL TOLERANCES		REVISION CONTROL	
NOMINAL:	UP TO 1000mm	1M AND ABOVE	FLATNESS: (NOT INCLUDING BROOME FINISH)
TOLERANCE:	±5mm	1mm IN 200mm UP TO A MAXIMUM OF 20mm	±4mm PER 1M WIDTH IN 1M LENGTH

CHK / APPR:	AC
DATE:	
RPEQ DOCUMENT #:	
WEIGHT:	94Kg
MATERIAL:	MATERIAL <NOT SPECIFIED>
IRF REF:	

CUBIS SYSTEMS
A CRH COMPANY

HEAD OFFICE:
CARNHAM ROAD
BALLARAT, VIC 3351
(03) 5335 8741

ENGINEERING & DEVELOPMENT:
91 STRADBROKE STREET
HEATHWOOD, QLD 4110
(07) 3714 0444

THE INFORMATION DISCLOSED IN THIS DOCUMENT IS CONFIDENTIAL AND IS NOT WITHOUT THE EXPRESS CONSENT OF CUBIS SYSTEMS

AUSTRALIA TO BE COPIED, REPRODUCED, OR GIVEN TO ANY OTHER PARTY IN ANY FORM AND THAT ALL COPYRIGHT, DESIGNS AND PATENTS VEST IN CUBIS SYSTEMS AUS.

DRAFTED DATE:	30/05/2019
DRAFTED BY:	
DATE LAST SAVED:	17/11/2021
LAST SAVED BY:	CABEYSINGH
DRAWN TO AS 1100	DO NOT SCALE FROM SHEET

PART/PRODUCT #	50201203	QUOTE #		ORDER #	
REINFORCEMENT COMPUTATION		PIT #		ITEM TYPE	
CLIENT					
PROJECT DESC	AX S™ SCEC SL1 TO SUIT 1100x900 OPENING COVER GMS				
DRAWING NAME	SCEC SL1 COVER SET, 911/C1				
DRAWING #	50201203	PAGE	1 / 1	SHEET SIZE	A3
SCALE	1:10				
REV.	1				